



# Locu Adjustable Floodlights Installation Instructions



## Product Specifications

Model No.	HV3731T-BLK-PIR	HV3732T-BLK-PIR	HV3733T-BLK-PIR	HV3731T-BLK	HV3732T-BLK	HV3733T-BLK
Model Type	With Sensor			Without Sensor		
Name	Locu			Locu		
Material	Aluminium			Aluminium		
Colour	Black			Black		
Detection Range	Up to 10m (Installed at height of 2.5m)			N/A		
Detection Angle	120°			N/A		
Lux Adjustment	3-1000 Lux			N/A		
Time Adjustment	8 Seconds to 12 Minutes			N/A		
IP Rating	IP65			IP65		
Installation Type	Wall - Surface Mounted			Wall - Surface Mounted		
Tilt	240°			240°		
Input Voltage	240v AC			240v AC		
Protection Class	1 (Earth Required) 			1 (Earth Required) 		
Lamp Base	Built in LED			Built in LED		
Lamp Wattage	12w	24w	36w	12w	24w	36w
Colour Temp	TRI Colour - 3000k, 4000k, 5500k			TRI Colour - 3000k, 4000k, 5500k		
Lumens	590lm, 660lm, 610lm	1350lm, 1410lm, 1390lm	2710lm, 2430lm, 2225lm	590lm, 660lm, 610lm	1350lm, 1410lm, 1390lm	2710lm, 2430lm, 2225lm
CRI	> 80			> 80		
Dimmable	No			No		
Warranty	3 Years Replacement*			3 Years Replacement*		

### HV3731T Dimensions:

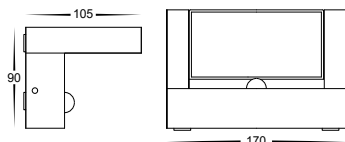

### HV3732T Dimensions:

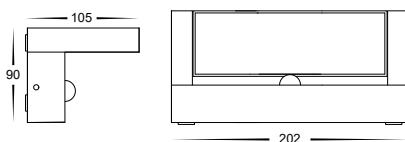

### HV3733T Dimensions:

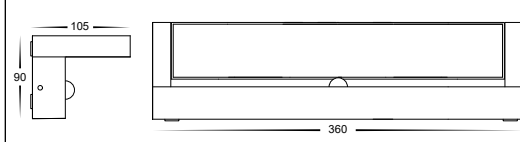

### HV3731T Mounting Base Dimensions:

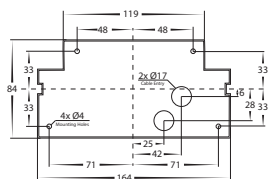

### HV3732T Mounting Base Dimensions:

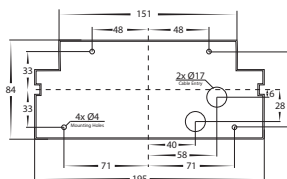

### HV3733T Mounting Base Dimensions:

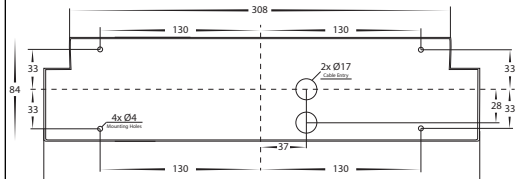

## Important Safety Issues:

- This product must be installed by a qualified electrician according to AS/NZS 3000.
- Ensure all electrical mains are disconnected before any installation.
- Modification of this product will void any warranty.
- Havit Lighting does not take responsibility for wrong installation, incorrect use, or use of installation material that does not belong to the system.
- Aluminium and 304SS fittings must not be installed within 5km of any salt water environments.
- All o-rings and seals must be in place correctly to maintain warranty.
- Fitting must not be installed onto surfaces which may cause damage to fitting eg. Sandstone or Bush Rock
- Sensor Detection range will vary depending on installation height, For best results install at a height between 2-2.5m
- Avoid aiming the motion sensor at pools, heating vents, air conditioners or objects which may change temperature rapidly.
- Do not allow sunlight to fall directly on the front of unit.
- These instructions may be updated at any time due to product improvements. Please visit website for most current installation instructions.

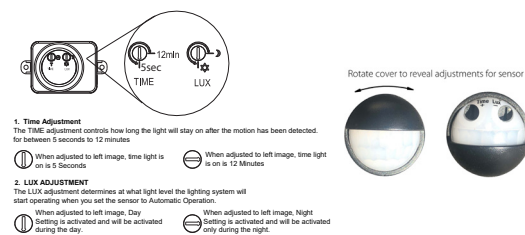

## Steps for Installation:

1. Make sure that the electrical circuit is free of voltage (master switch off)
2. Loosen allen screws on side of base and separate mounting bracket from fitting.
3. Insert cables through cable entry holes.
4. Install the backing plate securely using appropriate screws for application, Seal all holes in the backing plate including cable entry and screw holes. Failure to do so will void warranty.
5. Connect the cable - use wire with earth; connect the earth first, then live and neutral wire.
6. Colour temperature is preset to 3000k, to change slide switch located behind in base of fitting to desired colour temperature.
7. Affix the fitting to the mounting bracket and tighten allen screws, making sure these are tight to avoid any water penetration.
8. Apply silicon seal around the whole base plate to avoid any water getting into electrical connections.
9. Adjust fitting to desired position making sure to stop rotating when fitting cannot rotate anymore, If forced fitting will continue to rotate and cause internal cables to become entangled causing fitting to short. If this is done, warranty will be voided.
10. For Sensor models, adjust the Sensor Settings
  - To adjust Sensor, rotate cover on sensor to the left or right to show settings
  - Adjust time, use a flat head screwdriver and rotate position to the right up to a maximum of 12 mins
  - Adjust Lux settings, use a flathead screwdriver and rotate position to the right to only have light fitting turn on at night.
  - Manual Override Function - If Option 1 does not work, refer to option 2.
    - Option 1 - Switch light off and then back on within 2 seconds for light to stay permanently on, To return light back into sensor mode, Switch off for 1 minute then back on.
    - Option 2 - Switch light off and then back on twice slowly for light to stay permanently on (Light will flash to indicate override has been activated), To return light back into sensor mode, repeat same step, (Light will flash to indicate override has been de-activated),
11. All connections must be carried out carefully, inspect all contacts before switching back on the electric circuit.

## Must be installed by a licensed electrician

### Contact Details:

143 Beauchamp Road  
Matraville NSW 2036  
Australia  
Tel: 02 9381 8300  
Fax: 02 9666 8881  
Email: sales@havit.com.au  
Web: www.havit.com.au

### Warranty Terms & Conditions\*



### www.havit.com.au

